

ABC 5 [Sem V] Exam Oct 2021 [Part I]

University of Mumbai
Architecture, Navi Mumbai

Mahatma Education Society's Pillai College of
Bachelor of Architecture Examinations

~~2021~~

Subject: Architectural Building Construction 5

Subject Code: BARC 503

Semester V

Maximum Marks: 20

Minimum Passing

Marks: 20 [Combined]

Date: 08/03/2022

Time: 10.00 a.m.

Duration: half hour [30 Minutes]

Note : All questions are compulsory.

radhikasathe@mes.ac.in Switch account



Your email will be recorded when you submit this form

* Required

Q 5. Identify the joint details given in the figure below,

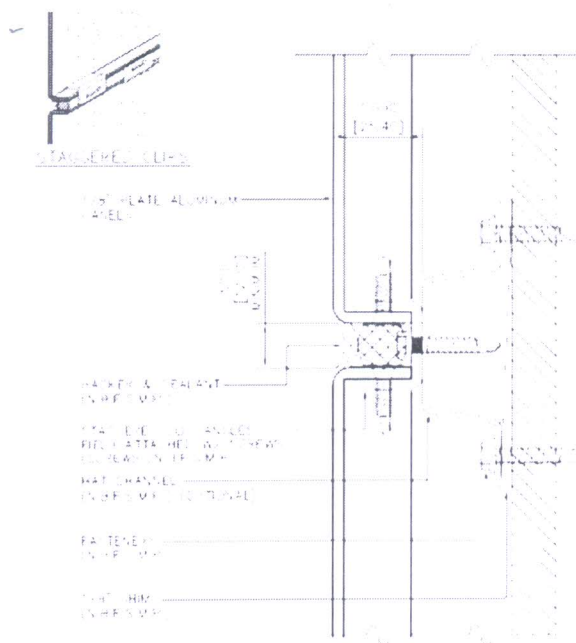

- ☐ Joint bet. two Panels.
- ☐ Out side corner.
- ☐ Soffit of a projected portion of a bldg. or window.
- ☐ Non of the above.

Q 7. What may change or differ according to the type of Foundation,

- ☐ Thickness or Depth of the Foundation.
- ☐ Area required for the Foundation.
- ☐ Non of the above.

Q 9. Buoyancy Blocks used in Buoyant Foundation House are made from,

- ☐ Expanded Aluminium.
- ☐ Expanded Polystyrene.
- ☐ Both of the above.

PL WRITE YOUR NAME & SEAT NO. BELOW

Your answer

Q 6. Functions of a Canopy is,

- ☐ to protect from weather conditions.
- ☐ identify an entrance to a building.
- ☐ both of the above.

Q 4. Metal Cladding Panel are fixed by,

- ☐ Modular Click Rail System.
- ☐ Mono-click Bracket System.
- ☐ Both of the above.

Q 10. Trapezoidal Footing is used where,

- ☐ One of the column is carries heavier loads.
- ☐ Length of Foundation is restricted.
- ☐ Non of the above.

Q 8. By use of Beams in Raft Foundation, Thickness of Raft Slab can be,

- ☐ Reduced.
- ☐ Increased
- ☐ Non of the above.

Q 1. External cladding are made from,, *

- ☐ Bricks, Blocks or Stones.
- ☐ Earth or Concrete.
- ☐ Light-weight Sheets or Framed Panels.
- ☐ Non of the above.

Q 3. Requirements of an Infill Panel are,

- ☐ Light weight.
- ☐ Rigid, impermeable & durable.
- ☐ Resistance to Fire & Weather.
- ☐ All of the above.

Q 2. Curtain Wall System is,

- ☐ External Finishing like Facings.
- ☐ Cladding with Glass & Infill Panels.
- ☐ Non of the above.

Clear form

Never submit passwords through Google Forms

This form was created inside of Mahatma Education Society [Report Abuse](#)

Google Forms



Submit response?

Your username (picalibrary@mes.ac.in) and responses will be recorded when you submit this form.

[SWITCH ACCOUNT](#)[SUBMIT](#)

ABC 5 [Sem V] Exam Mar 2022 [Part II]

University of Mumbai
Architecture, Navi Mumbai
2022

Mahatma Education Society's Pillai College of
Bachelor of Architecture Examinations Mar

Subject: Architectural Building Construction 5 [Part II]

Subject Code: BARC 503

Semester V

Maximum Marks: 30

Minimum Passing

Marks: 20 [Combined]

Date:

08/03/2022 TIME: 10.45 A.M.

Duration: 1

hour [60 Minutes]

Important Notes:

1. Attempt All 6 [Six] Questions.
2. All Questions carry 5 [five] marks each.
3. Draw free-hand sketches to explain all the questions & upload in "SKETCHES" assignment created on

G Class Room - "ATKT EXAM ABC 5 SEM V MAR 22".

picalibrary@mes.ac.in [Switch account](#)



Your email will be recorded when you submit this form

PL WRITE YOUR NAME & SEAT NO. BELOW.

Your answer

Q. 1 Describe in detail Curtain Wall System & its components in Plan and Section.

Your answer



Q. 2 What are the functional requirements of an Infill Panel used in Curtain Wall System?

Your answer

Q. 3 What is a Canopy? Describe its Components including its Structural system.

Your answer

Q. 4 Explain the different types of Shallow Foundations in Sections & its uses..

Your answer

Q. 5 Describe Raft Foundation, its types & also explain how it differs in transferring load..

Your answer

Q. 6 Explain Combined Footings & Describe its reinforcements in Plan and Section.

Your answer

Submit

Clear form

Never submit passwords through Google Forms.

This form was created inside of Mahatma Education Society. Report Abuse

Google Forms

